

F1 (Faston-Anschluss 4,75mm)

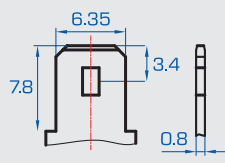

F2 (Faston-Anschluss 6,35mm)

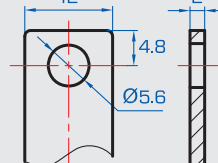

F3 (Anschluss Fahne)

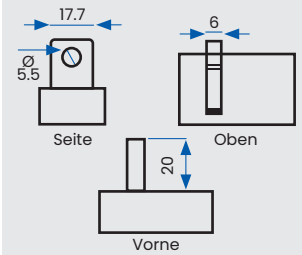

F4 (Anschluss Fahne)

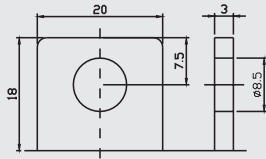

F5 (Anschluss Fahne)

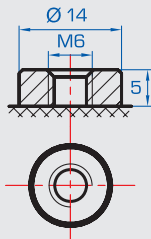

F11 (Schraubanschluss M6)

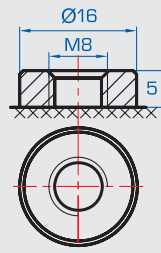

F12 (Schraubanschluss M8)

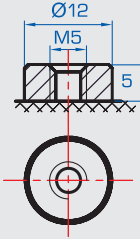

F13 (Schraubanschluss M5)

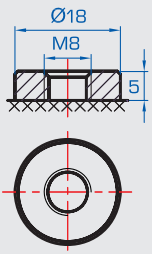

F14 (Schraubanschluss M8)

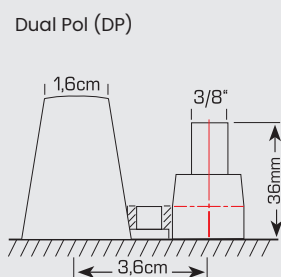

Dual Pol (DP)

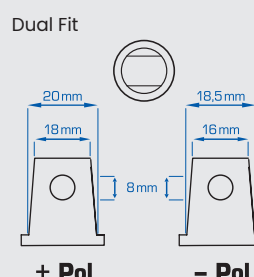

Dual Fit

+ Pol - Pol

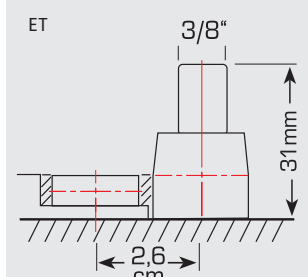

ET

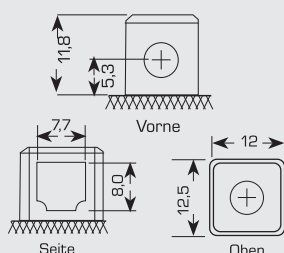

Motorrad Pol Y5

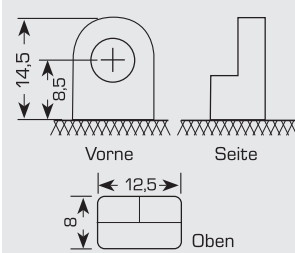

Motorrad Pol Y6

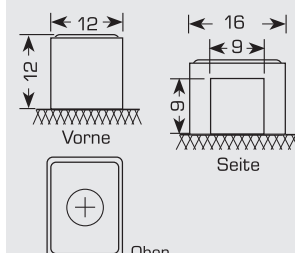

Motorrad Pol Y8

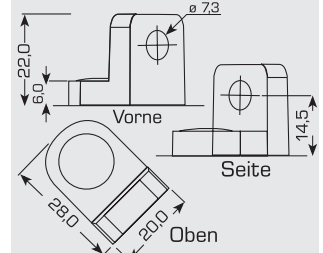

Motorrad Pol Y10

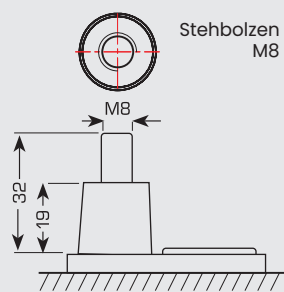

Stehbolzen M8

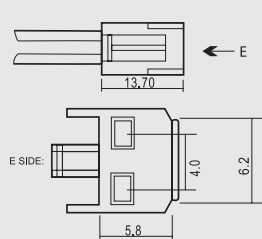

JST-Stecker

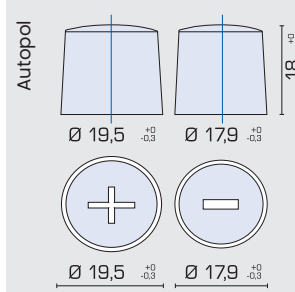

Autopol

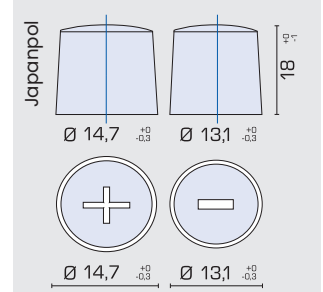
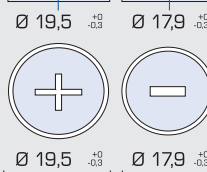

Japanpol

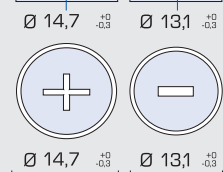

Bodenleiste B0

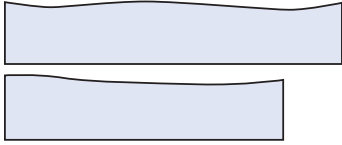

Bodenleiste B1

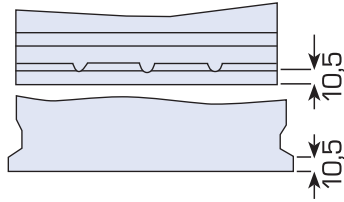

Bodenleiste B3

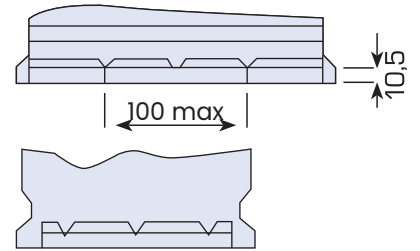

Bodenleiste B11

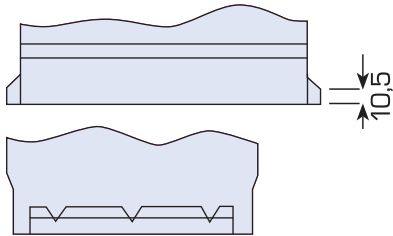

Bodenleiste B13

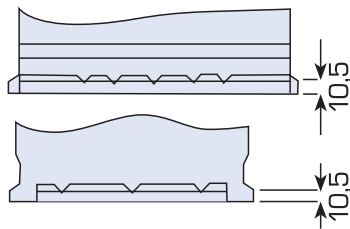

Korean B1

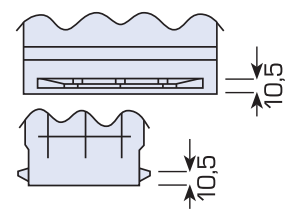

Schaltung 0

3

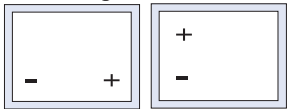

1

4

